

# Electric Razor

User's manual

EN



**SENCOR®**

SMS 2001BK  
SMS 2002RD  
SMS 2003BL

Prior to using this appliance, please read the user's manual thoroughly, even in cases where owners have previously familiarised themselves with using similar types of appliances. Only use the appliance in the manner described in this user's manual. Keep this manual for future use.

Save the original shipping box, packaging material, purchase receipt and warranty card for the duration of the warranty. In the event of shipping, pack the appliance using the original packaging materials only.

**CONTENTS**

IMPORTANT SAFETY INSTRUCTIONS .....	3
BEFORE USING .....	5
DESCRIPTION OF THE ELECTRIC RAZOR .....	5
CHARGING .....	6
CLEANING AND MAINTENANCE .....	7
REPLACEMENT OF THE SHAVING HEAD .....	8
TECHNICAL SPECIFICATIONS .....	9
INSTRUCTIONS AND INFORMATION REGARDING THE DISPOSAL OF USED PACKAGING MATERIALS ..	9
DISPOSAL OF USED ELECTRICAL AND ELECTRONIC APPLIANCES .....	9

## IMPORTANT SAFETY INSTRUCTIONS

- This appliance may be used by children 8 years of age and older and by persons with physical or mental impairments or by inexperienced persons, if they are properly supervised or have been informed about how to use the appliance in a safe manner and understand the potential dangers. Do not allow children to play with the appliance.
- Cleaning and maintenance must not be performed by children unless they are older than 8 years of age and under supervision. Keep this appliance and the power cord out of reach of children that are younger than 8 years of age.

## IMPORTANT SAFETY INSTRUCTIONS

### READ CAREFULLY AND STORE FOR FUTURE USE

- Carefully unpack the product and take care not to throw away any part of the packaging before you find all the parts of the product.
- Never use accessories that have not been delivered with this product or are not intended for it.
- Under no circumstances should you try to repair or amend the product on your own - danger of electric shock! Entrust all repairs and adjustments to a specialised company/service. Tampering with the product during the warranty period may void the warranty.
- Never use the product if you have wet hands or feet.
- Only store and use the product away from flammable or volatile materials and solutions.
- Keep the product away from extreme temperatures, direct sunlight and excessive humidity. Do not use in an overly dusty environment.
- Do not place the product near heaters, open fires or other appliances or equipment that are sources of heat.
- This appliance is designed for household use. Do not use it in industrial surroundings or outdoors!
- Do not use the product for purposes other than those intended.



#### WARNING:

Keep the appliance dry.

- Before connecting the product to the power outlet, ensure that the voltage on the rating label is the same as that in the power outlet.
- Do not place the power cord near hot surfaces, or over sharp objects. Do not place heavy objects on the power cord. Position the cord so that it will not be stepped on or tripped over. Make sure the power cord is not touching a hot surface.
- If the product's power cord is damaged, have an authorised service or qualified person replace it, in order to prevent hazards. It is forbidden to use a product with a damaged power cord or plug.
- Do not disconnect the power cord from the electric power socket by pulling the cable.
- It is forbidden to connect this product using an external trigger switch, timer or remote control.
- Do not spray the product with water or any other liquid. Do not pour water or any other liquids into the product. Do not submerge the product in water or any other liquid.
- Never recharge the product near a bathtub, wash basin or any other container filled with water.
- This electric razor is not designed for shaving in the shower.
- If you are not using the product, or if you know that you will not be using it soon, turn it off and disconnect the power cord from the wall socket. Prior to cleaning, proceed in the same manner.
- Never leave the product switched on without supervision.
- Use extra care if the product is used near children. Always keep the product out of reach of children. Children must be supervised to ensure that they do not play with the product.
- For plugging the product into the mains socket, use only the type of adaptor included with the product.
- Do not use this product if there are open wounds, cuts, sunburns or blisters on the face.
- Never use this product to cut animal fur.
- This product is designed only for shaving facial hair, it is not designed for shaving arm pit and groin areas and does not serve the function of an epilator.
- Keep this product at a safe distance from hair and eyes.
- The manufacturer is not responsible for damages caused by the incorrect use of this product or its accessories (food spoilage, injuries, burns, scalding, fire, etc.).

# Electric Razor

SMS 2001BK / SMS 2002RD / SMS 2003BL

EN

## BEFORE USING

It will take some time before you get used to your new electric razor because your skin and facial hair need approximately 2 - 3 weeks to become accustomed to any new shaving method.

Store and recharge the electric razor at a temperature of 5 - 35 °C.

## DESCRIPTION OF THE ELECTRIC RAZOR

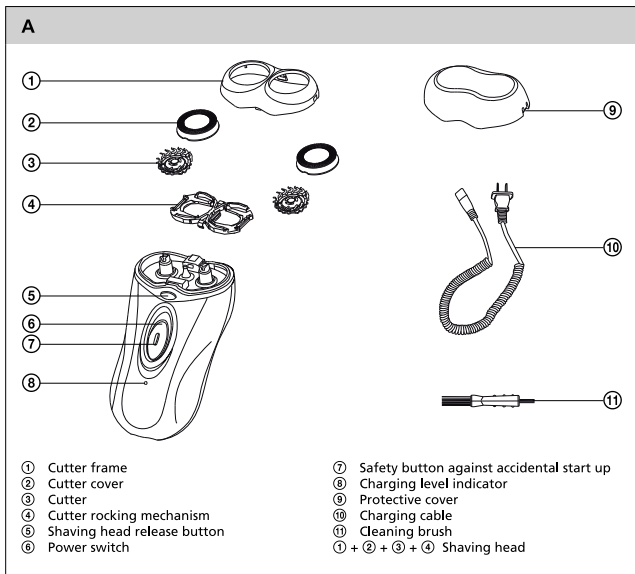

## CHARGING

If you are charging the electric razor for the first time or after an extended period of no use, allow it to charge continuously for at least 15 hours, e.g. overnight. A standard charge usually takes approx. 8 hours.

1. Prior to charging, make sure that the electric razor is turned off.
2. Connect the charger cable to the electric razor and the other end to a power socket - the indicator will be lit red during the charging process.
3. When it is fully charged, you can shave with this electric razor for approximately 45 minutes.
4. Do not leave it connected to the power socket for longer than 24 hours.

## USING THE ELECTRIC RAZOR

**B**

1. Remove the protective cover A⑨.
2. Turn on the electric razor by moving the power switch A⑥ upwards while at the same time holding down the safety button A⑦.
3. Move the electric razor quickly over your skin in the opposite direction to the growth of your facial hair. In order to achieve the best results, combine straight and rotating movements. It is not necessary to moisten the skin before shaving or to use a shaving cream or gel.

**Attention:**

The use of a shaving cream or gel will result in the irreparable destruction of the electric razor!

4. After you have finished shaving, turn off the electric razor by moving the power switch A⑥ downwards while at the same time holding down the safety button A⑦.
5. Clean out the electric razor after every shave (see following chapter) and place the protective cover A⑨ on to it.

## CLEANING AND MAINTENANCE

Regular cleaning of the electric razor after every shave will extend the lifetime of the cutters and you will achieve better shaving results.

**⚠ Attention:**  
This electric razor is non-washable - none of its parts may be washed using water or any other liquids or cleaning agents.

1. Turn off the electric razor.
2. Remove the protective cover A⑥ (fig. C①).
3. Press the release button A⑤ and take off the shaving head (see fig. C②).

**⚠ Tip:**  
It is best to remove the shaving head above a wash basin or waste bin, because after each shave, the area under the shaving head is full of facial hair clippings.

4. Push down both shaving cutter covers A② (see fig. D①) and carefully slide out the entire rocking mechanism A④ and the cutters A③ and their covers A②.
5. From the rocking mechanism A④, remove both the cutters A③ together with their covers A② by moving them to the side (see fig D② and D③).

**⚠ Attention:**  
The bottom strips of the rocking mechanism A④ are very sharp - be very careful when handling them!

6. The cutters A③ will fall out of both the covers A②.

**⚠ Attention:**  
The cutters are very sharp and careless handling may lead to cuts - pay extra attention when handling them in any way!

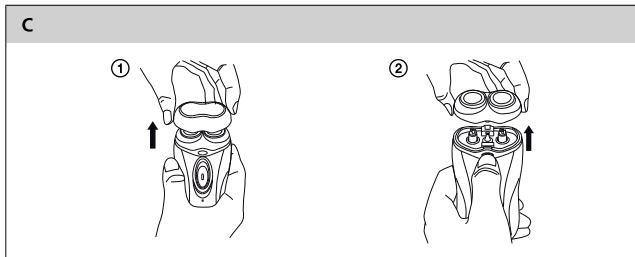

D



7. Use the supplied cleaning brush A① to clean out both the shaving head covers A② (see fig. E①) and both cutters A③ (see fig. E②). Also clean out the area under the shaving head (see fig. E③).
8. Now reinsert both the cutters A③ one by one into the covers A②
9. Then reinsert both the covers together with the cutters back into the rocking mechanism A④ and ensure that the edge cut-out of the cover A② fits precisely into the plastic boss in the central part of the rocking mechanism A④.
10. Now, insert the entire mechanism into the frame A① and gently push down in its central part so that both side strips lock into the frame A①. When correctly attached, both the cutter covers A② must extend above the frame A① by approx. 1.5 mm and must be able to freely tilt in all directions.
11. Then click the whole shaving head back into the electric razor.

E

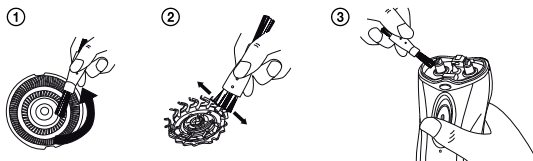

## REPLACEMENT OF THE SHAVING HEAD

In order to maintain maximum performance of your electric razor, we recommended that you replace the entire shaving head at least once every two years.

The shaving head consists of the rocking mechanism A④, two cutters A③, two cutter covers A② and a frame A①.

The shaving head is sold as a complete set under the model name SENCOR SMX 001.



## TECHNICAL SPECIFICATIONS

Length of the power cord .....	0.25 – 1.5 m
Dimensions (width x depth x height) .....	57 x 35 x 106 mm
Weight .....	107 g
Rated power input .....	2 W
Rated voltage .....	100–240 V
Rated frequency .....	50/60 Hz

We reserve the right to change text and technical specifications.

## INSTRUCTIONS AND INFORMATION REGARDING THE DISPOSAL OF USED PACKAGING MATERIALS

Dispose of packaging material at a public waste disposal site.

## DISPOSAL OF USED ELECTRICAL AND ELECTRONIC APPLIANCES



The meaning of the symbol on the product, its accessory or packaging indicates that this product shall not be treated as household waste. Please, dispose of this product at your applicable collection point for the recycling of electrical & electronic equipment waste. Alternatively in some states of the European Union or other European states you may return your products to your local retailer when buying an equivalent new product. The correct disposal of this product will help save valuable natural resources and help in preventing the potential negative impact on the environment and human health, which could be caused as a result of improper liquidation of waste. Please ask your local authorities or the nearest waste collection centre for further details. The improper disposal of this type of waste may fall subject to national regulations for fines.

### For business entities in the European Union

If you wish to dispose of an electrical or electronic device, request the necessary information from your seller or supplier.

### Disposal in other countries outside the European Union

If you wish to dispose of this product, request the necessary information about the correct disposal method from local government departments or from your seller.



This product meets all the basic EU regulation requirements that relate to it.

