

# Hair Clipper Set

User's manual

EN



**SENCOR®**

SHP 7411BK

Prior to using this appliance, please read the user's manual thoroughly, even in cases, when one has already familiarised themselves with previous use of similar types of appliances. Only use the appliance in the manner described in this user's manual. Keep this user's manual in a safe place where it can be easily retrieved for future use.

We recommend saving the original cardboard box, packaging material, purchase receipt and responsibility statement of the vendor or warranty card for at least the duration of the legal liability for unsatisfactory performance or quality. In the event of transportation, we recommend that you pack the appliance in the original box from the manufacturer.

## CONTENT

IMPORTANT SAFETY INSTRUCTIONS . . . . .	3
DESCRIPTION OF THE HAIR CLIPPER AND ITS ACCESSORIES . . . . .	8
POWER SOURCE . . . . .	9
ATTACHING AND REMOVING ATTACHMENTS . . . . .	10
SETTING THE CUTTING HEIGHT . . . . .	11
OPERATING THE HAIR CLIPPER . . . . .	12
CLEANING AND MAINTENANCE . . . . .	14
REPLACEMENT OF ATTACHMENTS . . . . .	15
STORAGE. . . . .	15
TECHNICAL SPECIFICATIONS . . . . .	15
DISPOSAL OF USED BATTERIES . . . . .	16
INSTRUCTIONS AND INFORMATION REGARDING THE DISPOSAL OF USED PACKAGING MATERIALS . . . . .	16
DISPOSAL OF USED ELECTRICAL AND ELECTRONIC EQUIPMENT . . . . .	16

## **IMPORTANT SAFETY INSTRUCTIONS**

### **READ CAREFULLY AND STORE FOR FUTURE USE.**

- This hair clipper may be used by children 8 years of age and older and by persons with physical or mental impairments or by inexperienced persons, if they are properly supervised or have been informed about how to use the hair clipper in a safe manner and understand the potential dangers. Cleaning and user maintenance must not be performed by children unless they are older than 8 years of age and under supervision. Children must not play with the hair clipper or its accessories. Keep the hair clipper and its accessories out of reach of children that are younger than 8 years of age. Accessories are understood to mean all parts supplied with this hair clipper including the power adapter.
- This hair clipper is intended for home use only and is designed for cutting human hair, beards and nose and ear hair.
- The hair clipper is not intended for commercial purposes or for trimming animal fur.
- The hair clipper and its power adapter must only be use in indoor areas. Do not use it outdoors.
- Do not use the hair clipper in rooms where aerosol sprays are used or where oxygen is administered.
- The hair clipper must only be used with the original power adapter that came with it.
- In order to avoid a dangerous situation from arising, never use a different type of power adapter.
- Never use the power adapter supplied with this hair clipper for any other purposes.

- Before connecting the power adapter to a power socket, check that the voltage on its rating label corresponds to the voltage in the power socket to which you wish to connect it. Do not use an extension cord.
- Use only the original accessories supplied with this hair clipper.
- Do not expose the hair clipper and its accessories to the outdoor environment, extreme temperatures, direct sunlight, excessive humidity or excessively dusty environments.
- Do not place the hair clipper and its accessories near heaters, open fires or other sources of heat.
- Store, charge and use the hair clipper at an ambient temperature of 15 to 35 °C. Do not charge the hair clipper for longer than is necessary for it to fully charge. Once it is charged, disconnect it from the power socket.
- Do not expose the hair clipper to temperatures higher than 50 °C. Otherwise, the built-in battery could be damaged.
- The hair clipper may heat up during use. This is a completely normal event.

**Warning:**

Do not use this appliance near baths, showers, washbasins or other containers containing water.

**Warning:**

Keep the hair clipper dry.

**Warning:**

Do not use the hair clipper in the bath or shower. Do not clean it under a water tap, do not spray it with water or any other liquid or submerge it in water or any other liquid.

- Do not charge, use or store the hair clipper or leave it lying in a bathroom or in locations where it could fall into a bath, wash basin or other containers filled with water.
- In the event that the hair clipper falls into water, under no condition reach for it, rather, immediately disconnect the power adapter from the power socket. Never use a hair clipper or power adapter that was submerged in water. Hand it over to an authorised service centre for inspection.
- Do not connect or disconnect the hair clipper to and from from a power socket with wet hands.
- Only use the cutting blade lubricating oil in accordance with the instructions in this user's manual. Do not use it for other purposes.



## **Attention:**

Store the cutting blade lubricating oil out of children's reach.

- Use the hair clipper and the individual cutting and comb attachments in accordance with the instructions contained in this user's manual.
- Before every use, check the cutting and comb attachments for damage. Never use a hair clipper with a damaged cutting or comb attachment.
- Only use the hair clipper on dry clean hair, beards or nose and ear hair. Do not use it on wet or just washed hair or on beards on which a shaving foam or gel, etc. is applied.
- Keep the hair clipper at a safe distance from eyes.

- Never insert the nose and ear hair trimmer attachment deeper than 5 mm into the nose or ear.
- Always turn off the hair clipper and disconnect it from the power socket when not using it, when leaving it without supervision and before attaching, removing or replacing attachments and before cleaning, maintenance or storage. Store the hair clipper and its power adapter in a dry environment.
- Keep the hair clipper clean. Perform cleaning and maintenance according to the instructions in chapter Cleaning and maintenance.
- Do not perform any other maintenance on the hair clipper than cleaning the individual parts of the hair clipper and lubricating the cutting blades as described in chapter Cleaning and maintenance.
- Do not disconnect the power adapter from the power socket by pulling on the power cord. This could damage the power adapter or the power socket. Disconnect the power adapter from the power socket by pulling on the plug.
- Do not place the power cord of the power adapter over sharp objects. Make sure that the power cord does not hang over the edge of a table or that it is not touching a heated surface.
- Keep the power adapter and its power cord dry.
- Do not wind the power cord of the power adapter around the handle of the hair clipper.
- If the power cord of the power adapter is damaged, it must be replaced by the manufacturer, its service technician or by a similarly qualified person, as this will prevent a dangerous situation from arising.

- Never use a hair clipper or power adapter that is damaged in any way.
- Do not use the hair clipper if it has fallen on the floor, if it was submerged in water, if it is not functioning correctly or if it is damaged in any other way.
- In order to prevent a hazardous situation from arising, do not repair the hair clipper or any of its accessories yourself or modify it in any way. For all repairs, contact an authorised service centre. By tampering with the product you risk voiding your legal rights arising from unsatisfactory performance or quality warranty.
- Instructions for the removal of the battery for the purpose of ecological disposal are provided in chapter Removing the battery at the end of the product's lifetime. Do not take the battery out for any other reason.



## **Warning:**

Never disassemble the battery, short circuit it, or throw it into a fire. Incorrect use, risks releasing toxic substances, or causing a fire or explosion.

# Hair Clipper Set

SHP 7411BK

## DESCRIPTION OF THE HAIR CLIPPER AND ITS ACCESSORIES

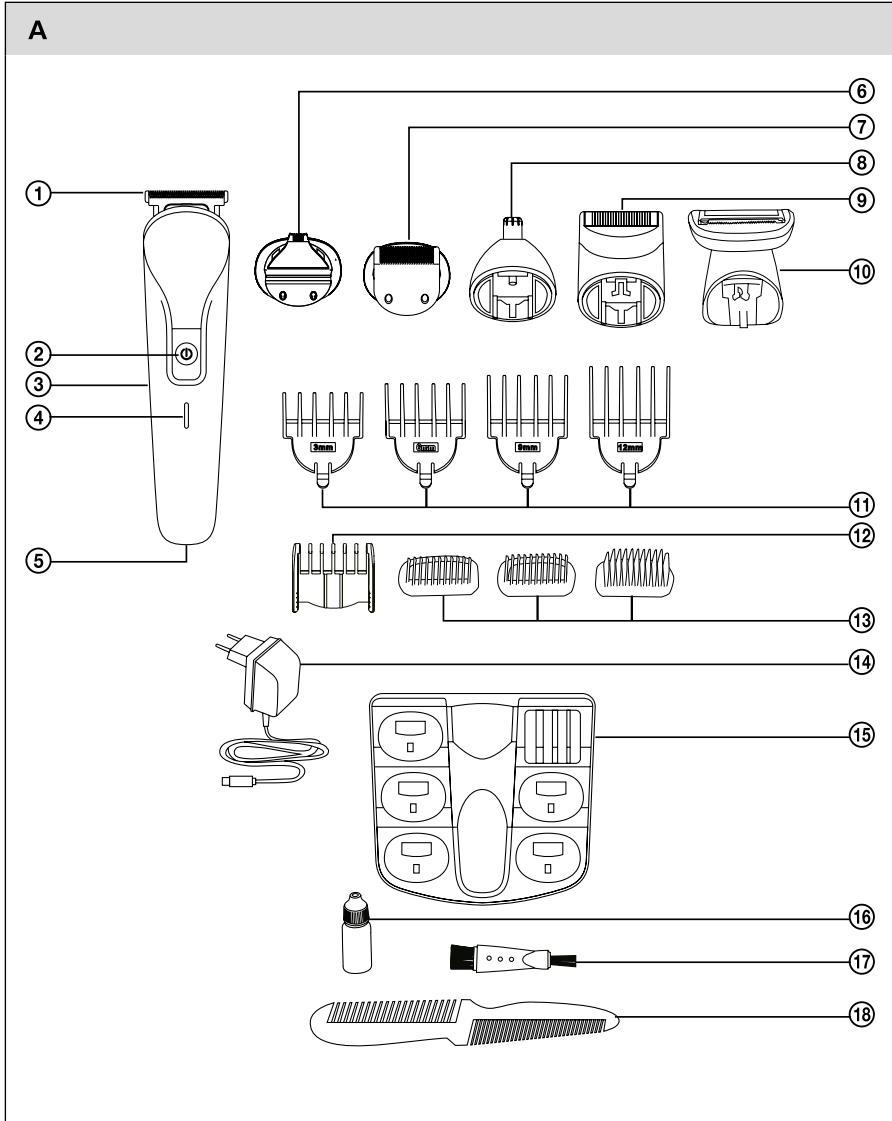



# Hair Clipper Set

SHP 7411BK

EN

- |                                                                                 |                                                                     |
|---------------------------------------------------------------------------------|---------------------------------------------------------------------|
| A① Basic hair clipper attachment, blade width 34 mm                             | A⑫ Comb attachment with an adjustable cutting height                |
| A② Button for turning the hair clipper on and off                               | of 4, 4.5, 5 and 5.5 mm                                             |
| A③ Ergonomically-shaped handle                                                  | it is attached to the precise trimming and clipping attachment.     |
| A④ LED charging indicator                                                       | A⑬ Comb attachments with fixed cutting height 3, 5 and 7 mm         |
| A⑤ Micro USB socket                                                             | they are attached to the body hair trimming and shaving attachment. |
| A⑥ Hair clipper attachment for styling precise contours, blade width 6 mm       | A⑭ Power adapter with micro USB connector                           |
| A⑦ Hair clipper attachment for precise trimming and clipping, blade width 26 mm | A⑮ Hair clipper and accessory stand                                 |
| A⑧ Nose and ear hair trimmer attachment                                         | A⑯ Cutting blade lubricating oil                                    |
| A⑨ Beard shaving attachment                                                     | A⑰ Cleaning brush                                                   |
| A⑩ Body hair trimming and shaving attachment                                    | A⑱ Comb                                                             |
| A⑪ Comb attachments with a fixed cutting height of 3, 6, 9 and 12 mm            |                                                                     |
| they are attached to the basic hair clipper attachments.                        |                                                                     |



## Note:

The individual comb attachments A⑪ and A⑬ are marked with the cutting height. The comb attachment A⑫ is marked with the adjustable positions, which correspond to the cutting heights as shown in the table included in chapter Setting the cutting height.

## POWER SOURCE

- This hair clipper can be powered both from an external as well as the internal power source. Before first use or after a long period of non-use, allow the hair clipper to first fully charge according to the instructions contained in subchapter Internal power source.

### EXTERNAL POWER SOURCE

- To power the hair clipper from an external power source, only use the original power adapter A⑭ (output 5 V<sub>DC</sub>, 1 A)
- Check that the hair clipper is turned off and connect the micro USB connector of the power adapter A⑭ to the micro USB socket A⑤. Insert the power adapter plug A⑭ into a power socket. After connecting to a power socket, the LED indicator A④ will be lit.
- When the hair clipper is powered from a power socket, allow it to cool down after 30 minutes of continuous operation.
- When you have finished using the hair clipper, always turn it off and disconnect it from the power socket. First, pull the power adapter plug A⑭ out of the power socket and only then disconnect the power adapter's micro USB connector from the micro USB socket A⑤.

### INTERNAL POWER SOURCE

- The hair clipper is equipped with a built-in Li-Ion battery (3.6 V<sub>DC</sub>, 600 mAh), which serves as an internal power source and enables cordless operation of the hair clipper.
- Before first using the hair clipper, regardless of the external power source, allow the built-in battery to fully recharge. To charge the battery, connect the hair clipper to an external power source according to the instructions contained in the preceding subchapter. Only use the original power adapter A⑭.
- The built-in battery will start charging after connecting the hair clipper to a power socket. The red lit LED indicator A④ signals that the battery is charging. Thanks to rapid charging technology, a full charge takes only approximately 2 hours. When the battery is fully charged, the LED indicator A④ will be lit green.
- At the end of the charging process, disconnect the power adapter plug A⑭ from the power socket and then disconnect the power adapter's micro USB connector A⑭ from the USB socket A⑤. When the hair clipper is disconnected from the external power source, the LED indicator A④ will turn off.

# Hair Clipper Set

SHP 7411BK



## Attention:

Do not leave the hair clipper connected to the external power source for longer than is necessary to charge it.

- A fully charged battery will provide approximately 120 minutes of cordless operation. Then it is necessary to charge the battery again.
- Recommendations for achieving the longest possible battery lifetime:
  - In order for the built-in battery to serve you as long as possible, charge, use and store the hair clipper in a dry environment at an ambient temperature of 15–35 °C. Lower or higher temperatures have a negative impact on the lifespan of the battery.
  - Do not wait for the battery to become completely flat. It is better to charge the battery before it is completely flat.
  - When the hair clipper is not used for an extended period of time, charge it at least once every 6 months.

## ATTACHING AND REMOVING ATTACHMENTS

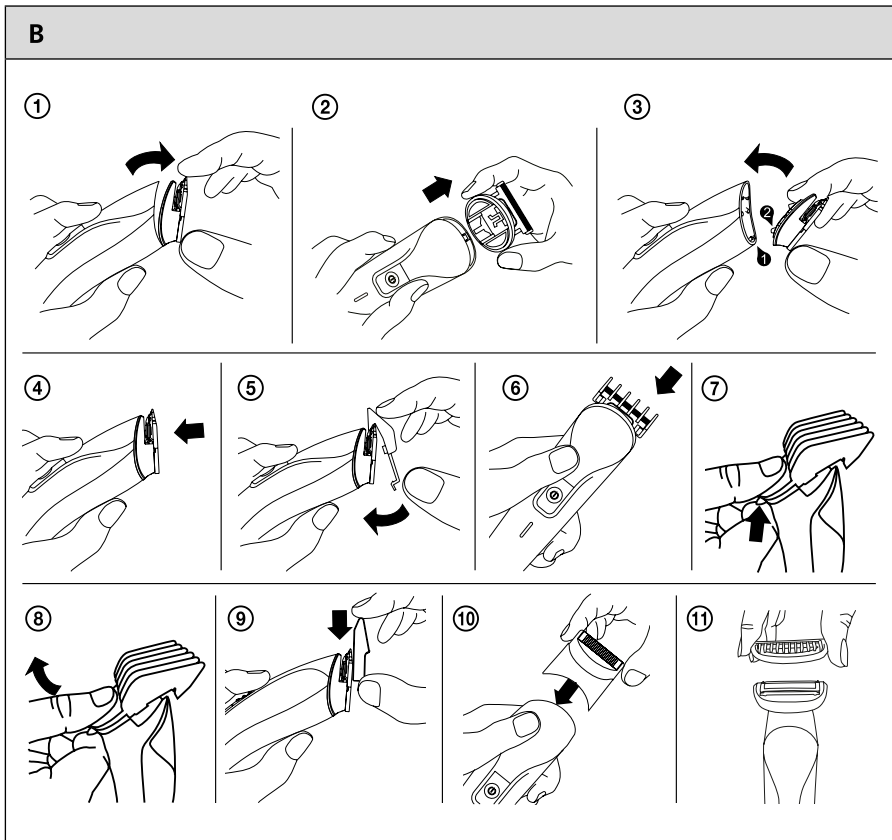

# Hair Clipper Set

SHP 7411BK

EN

- Before attaching, removing or replacing the attachments, turn the hair clipper off and disconnect it from the power socket.
- To remove the hair clipper attachment A①, proceed according to figure B① and B②. At the same time, hold handle A③ in such a way that button A② is not pressed. In the same way, remove attachment A⑥ and A⑦.
- To attach the hair clipper attachment A① to the handle A③, proceed according to figure B③ and B④. The clip on the underside of the attachment A① must first slide into place on the handle A③ and then it is necessary to push the attachment A① towards the handle A③ until it is secured in place. This is indicated by a click. In the same way, attach attachment A⑥ and A⑦.
- To attach the comb attachment A⑪ to the hair clipper attachment A①, proceed according to figure B⑤ and B⑥. First slide the comb attachment A⑪ on to the trimmer blade from above and then push it against the hair clipper attachment A① until it is fully attached.
- To remove the comb attachment A⑪ proceed according to figure B⑦ and B⑧. Push the clip of the comb attachment A⑪ from underneath. This will release it and then remove it by pulling it upwards.
- Attach the comb attachment A⑫ to the hair clipper attachment A⑦, according to figure B⑨. Slide the comb attachment A⑫ on to the hair clipper attachment A⑦ from above so that the sides of the hair clipper attachment A⑦ slide into the horizontal grooves on the comb attachment A⑫. Slide the comb attachment A⑫ downwards so that the tabs on both sides of the hair clipper attachment A⑦ marked by arrows slide into the grooves for setting the cutting height.
- To remove, slide out the comb attachment A⑫ in the direction of the hair clipper attachment A⑦.
- Attach the beard shaving attachment A⑨ to the handle A③ according to figure B⑩. The clip on the underside of the attachment A⑨ must first slide into place on the handle A③ and then it is necessary to push the attachment A⑨ towards the handle A③ until it is secured in place. This is indicated by a click.
- To remove it, hold the attachment A⑨ by its sides and remove it by pulling it away from the handle A③.
- Attaching and removing attachments A⑩ and A⑨ is performed in the same way as with attachment A⑨.
- Attach the comb attachment A⑬ to the body hair trimming and shaving attachment A⑩ according to figure B⑪. Put the comb attachment A⑬ on to attachment A⑩ so that the comb tines point forward and then push it on to attachment A⑩ so that the clips on the underside of the comb attachment A⑬ slide into the grooves on attachment A⑩.
- To remove it, first release one of the clips from the groove and then remove the comb attachment A⑬ by pulling it away from attachment A⑩.

## SETTING THE CUTTING HEIGHT

- The comb attachment A⑫ enables the setting of four different cutting heights. The cutting height is set by sliding the comb attachment A⑫ that is attached to the hair clipper attachment A⑦ up and down. Attachment A⑫ can be set to four different positions according to the following table. The set position is marked by an arrow on the attachment A⑦.

Position	Cutting height in mm
1	4
2	4,5
3	5
4	5,5

## OPERATING THE HAIR CLIPPER

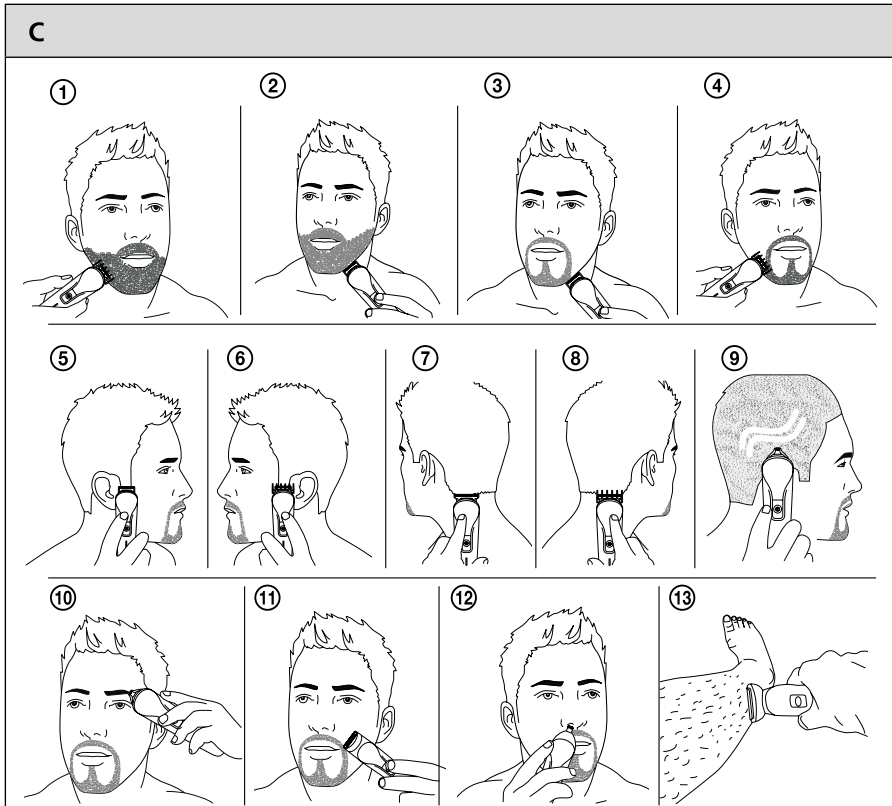

- Select an appropriate type of attachment and attach it to the hair clipper.
- Before every use, check the hair clipper, shaving or comb attachment for damage. Never use a hair clipper with a damaged attachment.
- Only use the hair clipper on dry clean hair, beards or nose and ear hair. Do not use it on wet or just washed hair or beards on which a shaving foam or gel, etc. is applied.
- Before starting any styling of hair, beards or nose and ear hair, acquaint yourself with the operating instructions.

## TURNING THE HAIR CLIPPER ON AND OFF

- Turn the hair clipper on and off using button A②.

**Attention:**

The cutting blades will cut off all hair, beards or nose and ear hair that comes into contact with them, therefore be especially careful when handling the hair clipper while it is running.

- When you have finished using it, always turn the hair clipper off by pressing button A② and disconnect it from the power socket if it was powered from a mains power socket. Then clean it out according to the instructions in chapter Cleaning and maintenance.

### TRIMMING BEARDS (FIGURE C1 and C2)

- For trimming beards, use attachment A⑦ with comb attachment A⑱. If you are using the hair clipper for the first time, we recommend setting the maximum cutting height.
- In order to achieve an evenly trimmed beard, keep the comb attachment A⑱ in contact with the skin and slowly move the hair clipper counter to the growth direction of the beard. Do not exert too much pressure and do attempt to rush the process too much.
- Regularly remove beard hair that has accumulated in attachment A⑱. Turn the hair clipper off prior to removing the beard hair.
- You may use hair clipper attachment A⑦ also independently without the comb attachment A⑱. This will correspond to a cutting height of approximately 0.5 mm.

### STYLING AND TRIMMING GOATEES AND MOUSTACHES (FIGURE C3 and C4)

- For styling goatees and moustaches, use attachment A⑦. Hold the hair clipper in such a way that the attachment is in contact with the skin. Do not exert too much pressure on the skin. Trim the beard on the required parts of the face using light and slow strokes until the required goatee or moustache shape is achieved. Trim the beard on the neck using movements away from the goatee.
- For trimming goatees and moustaches, use attachment A⑦ with comb attachment A⑱.
- After attaching comb attachment A⑱, set the required cutting height. If you are using the hair clipper for the first time, we recommend setting the maximum cutting height. To ensure an evenly trimmed beard, the comb attachment A⑱ must constantly remain in contact with the skin. Do not exert too much pressure on the skin. Trim the goatee or moustache using light and slow strokes.
- Regularly remove beard hair that has accumulated in attachment A⑱. Turn the hair clipper off prior to removing the beard hair.

### STYLING AND TRIMMING SIDEBURNS (FIGURE C5 and C6)

- For styling sideburns, use attachment A⑦. For trimming sideburns, use attachment A⑦ with comb attachment A⑱. After attaching comb attachment, set the required cutting height.
- Make sure that the hair clipper attachment A⑦ or comb attachment A⑱ remains in constant contact with the skin. This will ensure an even cut.
- Style the desired sideburns or trim the sideburns to the required length using light and slow strokes. Do not exert too much pressure on the skin.

### STYLING AND TRIMMING HAIR CONTOURS IN THE AREA OF THE NAPE AND NECK (FIGURE C7 and C8)

- To style hair contours in the area of the nape and neck, use attachment A① without comb attachment A⑩. This will correspond to a cutting height of approximately 0.5 mm.
- To trim hair in the area of the nape and neck, use attachment A① with comb attachment A⑩. If you are using the hair clipper for the first time, we recommend starting with the comb attachment A⑩ with the cutting height set to 12 mm.
- To achieve an even hair cut, we recommend that a second person assist you with trimming or styling hair contours in the area of the nape and neck. Otherwise, use a mirror. Keep the attachment in contact with the scalp and move the hair clipper slowly counter to the direction of hair growth.
- Regularly remove any hair that has accumulated in the attachment. Prior to removing the hair, turn off the hair clipper.

### STYLING PRECISE CONTOURS AND TRIMMING HAIR ALONG THE EYEBROWS (FIGURE C9 and C10)

- Attachment A⑥ may be used for creating various graphical motifs in hair or beards and for trimming hair along the eyebrow line. Attachment A⑥ is not intended for styling precise eyebrow contours.
- To achieve an even cut, make sure that the hair clipper attachment A⑥ remains in constant contact with the skin.

### SHAVING BEARDS (FIGURE C11)

- For shaving beards, use attachment A④. Prior to shaving, a long beard will need to be trimmed. Hold the foil at an angle of 90° relative to the skin. Perform short vertical strokes. Using the shaving foil, exert gentle pressure on the skin while using your other hand to tension the skin so that the beard is upright. On harder beards, it may be necessary to exert more pressure.

# Hair Clipper Set

## SHP 7411BK

- Attachment A⑨ is not designed for shaving the entire face. It is intended only for the final shave in the area of the contours around moustaches, goatees and sideburns.

### TRIMMING NOSE AND EAR HAIR (FIGURE C12)

- To trim hair inside the nose and ears, use attachment A⑧. Slowly place attachment A⑧ against the nasal or ear opening. Carefully move attachment A⑧ in and out of the nasal or ear opening while at the same rotating it until the required hair is removed.



#### Attention:

Never insert attachment A⑧ deeper than 5 mm into the nose or ear.

### TRIMMING AND SHAVING BODY HAIR (FIGURE C13)

- You may use attachment A⑩ to trim and shave hair on legs, the chest or in armpits. Gently move over the locations from which you wish to remove body hair.
- Attachment A⑩ may likewise be used in combination with comb attachment A⑬. To ensure evenly trimmed body hair, the comb attachment A⑬ must constantly remain in contact with the skin.

## CLEANING AND MAINTENANCE

- Before you start cleaning the hair clipper, turn it off and disconnect it from the power socket.
- Regular cleaning after every use will ensure its proper operation.



#### Attention:

This hair clipper is not designed to be washed under a water tap. Do not spray the hair clipper or its power adapter A⑭ with water or any other liquid or submerge it in water or any other liquid.

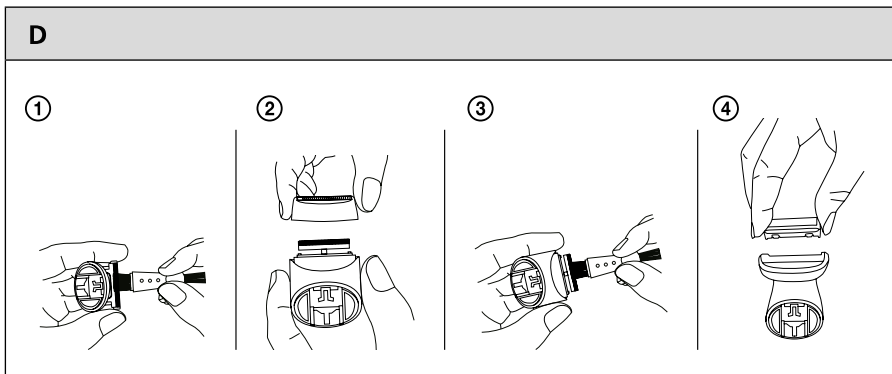

- If the comb attachment is attached to the hair clipper attachment, remove it. Remove the attachment that is attached to the handle A③.
- Use the brush A⑰ to remove all hair or beard remains from the cutting blade and all other parts of the hair clipper attachment A①, A⑥, A⑦ or A⑧, see figure D1. Then use the brush A⑰ to clean the top part of the handle A③ to which attachments are attached. Make sure that hair and beard remains or other material do not accumulate on the hair clipper attachment or in the top part of the handle. Remove the top part of the attachment from the beard shaving attachment A⑨ as shown in figure D2. Use the brush A⑰ to thoroughly clean the shaving razors and the area around the shaving razors, see fig. D3.



#### Attention:

Shaving razors are sharp, pay increased attention when handling them.

# Hair Clipper Set

SHP 7411BK

EN

Carefully blow out the shaving foil from inside and out or gently tap it on the edge of the attachment so that all beard remains are removed from the shaving foil. After cleaning it, reassemble it again properly. Remove the shaving head from attachment A⑩ by first releasing one of the trimming bars from underneath and then remove the entire shaving head from the attachment, see fig. D4. Use the brush A⑦ to thoroughly clean out the trimming bars, the shaving head from underneath and the area in which the head was mounted. Carefully blow out the shaving foil or gently tap on the edge of the shaving head so that all beard remains are removed from the shaving foil. Then properly assemble attachment A⑩ by attaching the shaving head back in its place.

- Removed attachments A①, A⑥, A⑦ and A⑧ can, likewise, be rinsed under lukewarm running water. After washing the attachment, carefully wipe it with a soft, dry cloth and then allow it to dry naturally. Do not wash attachments A⑨ and A⑩ under running water.
- After cleaning, apply a drop of oil A⑯ on to the trimming bar of attachments A①, A⑥, A⑦ and A⑩ and spread it evenly. Wipe off excess oil using a clean, dry cloth. When the supplied oil A⑯ is used up, use sewing machine oil exclusively. Never use hair oil, Vaseline, etc. to lubricate the trimming bars. Do not lubricate the foil and razors of the shaving attachments A⑨ and A⑩.
- Comb attachments A⑪, A⑫ and A⑬ can be washed under clean running water. After washing them, it is necessary to carefully wipe the attachments dry.
- The hair clipper handle A③ can be cleaned using a clean dry cloth. In the event that it is very dirty, you can use a lightly dampened cloth. Then thoroughly wipe the cleaned surface dry.
- After cleaning it, attach the required type of attachment back on to the handle A③. Make sure that the attachment is completely dry before attaching it.
- To clean the adapter A⑭, use a clean, dry cloth.
- For cleaning, do not use brushes with hard bristles, cleaning products with an abrasive effect, solvents, etc. Otherwise, the cleaned surface may be damaged.

## REPLACEMENT OF ATTACHMENTS

- In the event that the cutting blade or shaving razors are worn out, replace the respective attachment with a new one.
- Replacement attachments are available from you vendor both in online and brick&mortar stores.

## STORAGE

- When you have finished using it, you may store the hair clipper in the stand A⑱. Before placing the hair clipper into the stand A⑱, make sure that the stand A⑱ is located on a stable horizontal surface.

## TECHNICAL SPECIFICATIONS

### Hair clipper

Input..... 5 V $\overline{=}$ , 1 A  
Battery ..... Li-Ion, 3.6 V $\overline{=}$ , 600 mAh  
Noise level ..... 68 dB(A)

### Power adapter

Input ..... 100–240 V~, 50/60 Hz, 0.2 A  
Output ..... 5 V $\overline{=}$ , 1 A

The declared noise emission level of the appliance is 68 dB(A), which represents a level A of sound power with respect to a reference sound power of 1 pW.

We reserve the right to change text and technical specifications.

# Hair Clipper Set

SHP 7411BK

## DISPOSAL OF USED BATTERIES



This symbol indicates that used batteries do not belong in ordinary municipal waste. Hand over used batteries to designated collection points for proper disposal. Correct disposal of batteries will help prevent negative impacts on the environment and human health.

### **Disposal in other countries outside the European Union**

This symbol is valid in the European Union. If you wish to dispose of used batteries, request the necessary information about the correct disposal method from the local authorities or from your vendor.

## INSTRUCTIONS AND INFORMATION REGARDING THE DISPOSAL OF USED PACKAGING MATERIALS

Dispose of used packaging material at a site designated for waste in your municipality.

## DISPOSAL OF USED ELECTRICAL AND ELECTRONIC EQUIPMENT



This symbol on products or original documents means that used electric or electronic products must not be added to ordinary municipal waste. For proper disposal, renewal and recycling hand over these appliances to determined collection points. Alternatively, in some European Union states or other European countries you may return your appliances to the local retailer when buying an equivalent new appliance.



Correct disposal of this product helps save valuable natural resources and prevents potential negative effects on the environment and human health, which could result from improper waste disposal.

Ask your local authorities or collection facility for more details.

In accordance with national regulations penalties may be imposed for the incorrect disposal of this type of waste.

### **For business entities in European Union states**

If you want to dispose of electric or electronic appliances, ask your retailer or supplier for the necessary information.

### **Disposal in other countries outside the European Union**

This symbol is valid in the European Union. If you wish to dispose of this product, request the necessary information about the correct disposal method from the local council or from your retailer.



This product meets all the basic requirements of EU directives related to it.