

SENCOR®

SHP 4501BK

SHP 4502BL



EN ■ Hair Clipper

READ CAREFULLY AND STORE FOR FUTURE USE.

- This hair clipper may be used by children 8 years of age and older and by persons with physical or mental impairments or by inexperienced persons, if they are properly supervised or have been informed about how to use the hair clipper in a safe manner and understand the potential dangers. Cleaning and user maintenance must not be performed by children unless they are older than 8 years of age and under supervision.
- Children must not play with the hair clipper or its accessories.
- This hair clipper is intended for home use only and is designed for cutting human hair and beards. Do not use it for commercial purposes or for trimming animal fur.
- The hair clipper may only be used with the original power adapter that came with it.

Attention:

The hair clipper may only be charged using the original power adapter model TPA-593610V01 that came with it.

- In order to avoid a dangerous situation arising, never use a different type of power adapter.
- Never use the power adapter supplied with this hair clipper for any other purposes.
- Before connecting the adapter to a power outlet, make sure the voltage stated on its rating label corresponds to the voltage in your power outlet.
- Use only the accessories supplied with the hair clipper.
- Do not expose the hair clipper (including its accessories) to the outdoor environment, extreme temperatures, direct sunlight, excessive humidity or excessively dusty environments.
- Do not place the hair clipper (including its accessories) near heaters, open fires or other equipment that is a source of heat.
- Do not expose the hair clipper to temperatures higher than 50 °C. Otherwise, the built-in battery could be damaged.
- Do not charge the hair clipper for longer than 8 hours or at an ambient temperature below 15 °C or above 35 °C.
- The hair clipper heats up during use and when charging. This is a completely normal event.
- Keep the hair clipper dry.

Warning:

Do not use the hair clipper in the bath or shower. Do not clean it under a water tap, do not spray it with water or any other liquid or submerge it in water or any another liquid.

- Do not store, charge or use the hair clipper with the power adapter connected when in a bathroom or in locations where it could fall into a bath, wash basin or other containers filled with water.

- Do not handle the hair clipper or its power adapter when you have wet hands.
- Only use the cutting blade lubricating oil in accordance with the instructions in this user's manual and store it out of children's reach.
- Before every use, check the cutting blades for damage. Never use the hair clipper if it has damaged cutting blades.
- Always turn off the hair clipper and disconnect it from the power adapter when not using it, when leaving it without supervision and before attaching, removing or replacing accessories and before cleaning and maintenance.
- Keep the hair clipper clean. Before cleaning, turn it off and disconnect it from the external power source.
- Do not disconnect the power adapter from the power socket by pulling on the power cord. This could damage the power adapter or the power socket. Disconnect the power adapter from the power socket by pulling on the plug.
- Do not place the power adapter cord over sharp objects.
- In the event that the hair clipper, comb attachment or the power adapter is damaged in any way, do not use it.
- To prevent a dangerous situation arising, in the event that the cord of the power adapter is damaged, the power adapter must be disposed of and replaced by the manufacturer or an authorised service centre.
- In order to prevent a hazardous situation arising, do not repair the hair clipper or any of its accessories yourself or modify it in any way. For all repairs, contact an authorised service centre. By tampering with the product you risk voiding your legal rights arising from unsatisfactory performance or quality warranty.
- Instructions for the removal of the battery for the purpose of ecological disposal are provided in chapter Removing the battery at the end of the product's lifetime.
- Never disassemble the battery, short circuit it, or throw it into a fire.

A

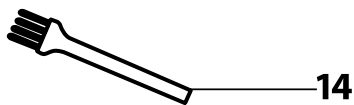
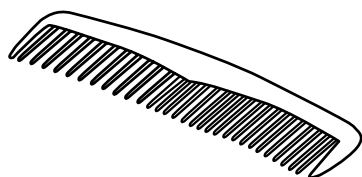
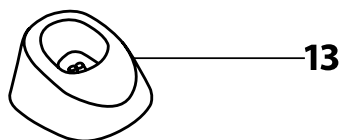
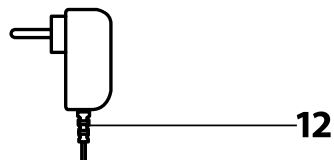
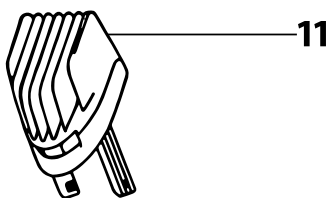
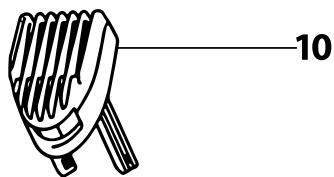
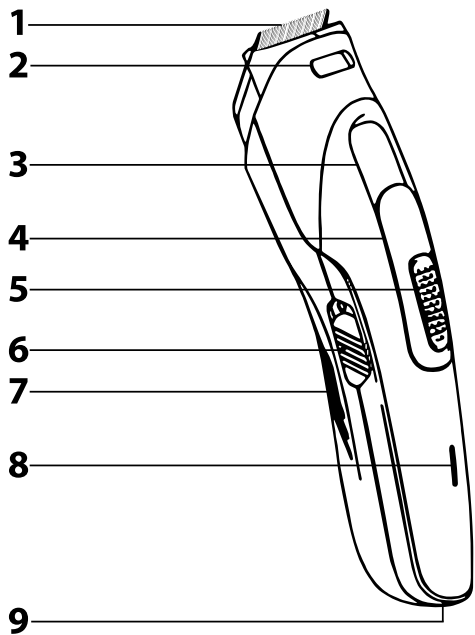

B

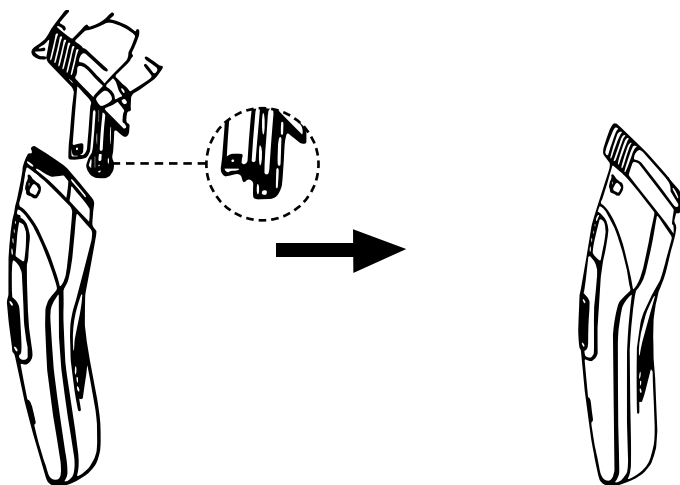

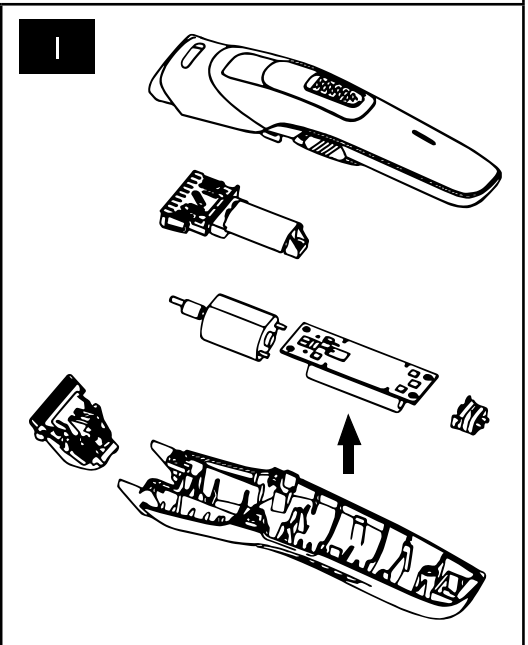
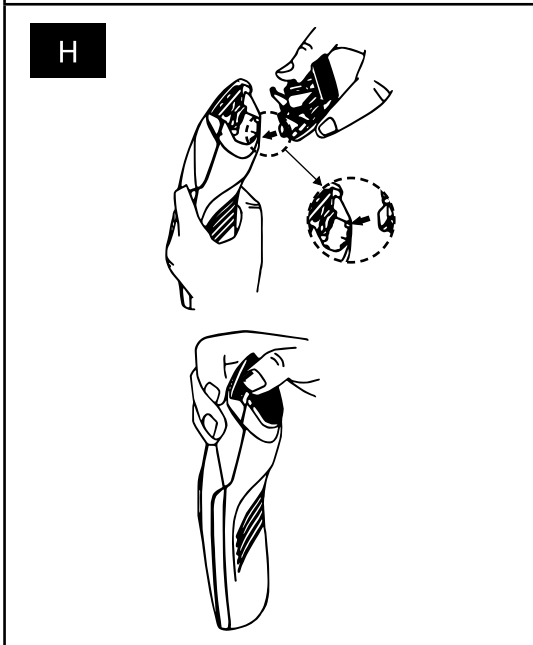
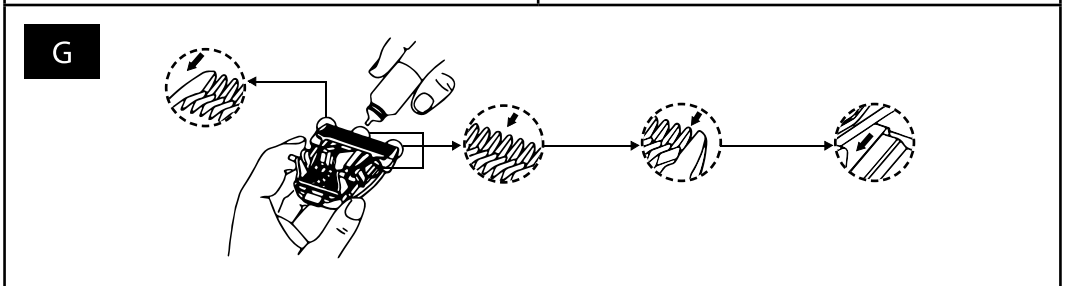
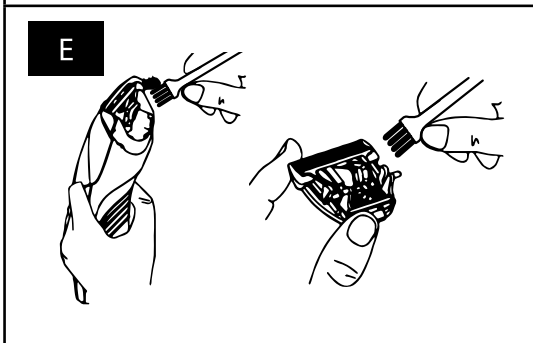
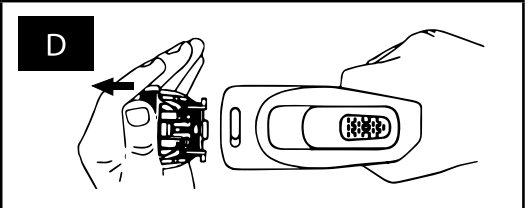
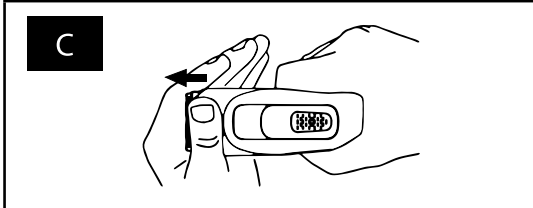

- Prior to using this appliance, please read the user's manual thoroughly, even in cases, when one has already familiarised themselves with previous use of similar types of appliances. Only use the appliance in the manner described in this user's manual. Keep this user's manual in a safe place where it can be easily retrieved for future use.
- We recommend saving the original cardboard box, packaging material, purchase receipt and responsibility statement of the vendor or warranty card for at least the duration of the legal liability for unsatisfactory performance or quality. In the event of transportation, we recommend that you pack the appliance in the original box from the manufacturer.

DESCRIPTION OF THE HAIR CLIPPER AND ITS ACCESSORIES

- | | |
|---|---|
| A1 Cutting blades, width 39 mm | A6 I/O switch (on/off) |
| A2 Slide switch for extending and retracting the hair thinning blade. | A7 Ergonomically-shaped handle |
| A3 Cutting height setting indicator | A8 LED charging indicator |
| The left scale shows the cutting height for the low comb attachment. The right scale shows the cutting height for the high comb attachment. | A9 Power adapter cord connector socket |
| A4 Cutting height slider adjusts the distance between the cutting blades and the comb attachment. | A10 Short comb attachment with cutting height settings from 3 to 24 mm |
| A5 Cutting height slider lock | A11 High comb attachment with cutting height settings from 14 to 35 mm |
| | A12 Power adapter |
| | A13 Stand |
| | A14 Cleaning brush |
| | A15 Cutting blade lubricating oil |
| | A16 Comb |

POWER SOURCE

- This hair clipper can be powered both from an external as well as the internal power source.

EXTERNAL POWER SOURCE

- To power the hair clipper from an external power source, use the original power adapter **A12** (output 3.6V \approx , 1 A).
- Check that the hair clipper is turned off and insert the power adapter connector into socket **A9** located on the underside of the hair clipper. Insert the power adapter plug into a power socket 100–240 V. When the hair clipper is connected to a power socket, the LED indicator **A8** will be lit.
- When the hair clipper is powered from a power socket, allow it to cool down after 40 minutes.

INTERNAL POWER SOURCE

- The hair clipper is equipped with a built-in Ni-MH battery (AAA, 2.4 V \approx , 650 mAh), which serves as an internal power source and enables cordless operation.
- In order for the built-in battery to serve you as long as possible, we recommend to charge, use and store the hair clipper in a dry environment at an ambient temperature of 15–35 °C. In the event that the hair clipper is stored at a temperature lower than 15 °C, allow it to stabilise to room temperature before charging or using it.
- Before first using the hair clipper, regardless of the external power source, allow the built-in battery to fully recharge. To charge the battery, connect the hair clipper to a 100–240 V power socket. Only use the original power adapter **A12**. A full charge takes approximately 8 hours.
- Before connecting the hair clipper to a power socket, check that the switch **A6** is set to position 0 (off). The built-in battery will start charging after connecting the hair clipper to a power socket. When the LED indicator **A8** is lit, this indicates that the hair clipper is charging.
- When you have finished charging, disconnect the power adapter **A12** from the power socket and then disconnect the power adapter cord connector from socket **A9**, which is located in the underside of the hair clipper. When the hair clipper is disconnected from the external power source, the LED indicator **A8** will turn off. A fully charged battery will provide approximately 40 minutes of cordless operation. Before using it again, allow the hair clipper to charge again.



Attention:

Do not leave the hair clipper connected to the external power source for longer than 8 hours.

- Recommendations for achieving the longest possible battery lifetime:
 - Do not wait for the battery to become completely flat. It is better to charge the battery before it is completely flat.
 - Ideally, store the hair clipper fully charged.
 - If you do not use the battery for a long time, charge it at least once every 6 months.

OPERATING THE HAIR CLIPPER

- The hair clipper is suitable for cutting dry or lightly dampened hair and beards. Do not use it to cut hair that has just been washed.
- Prior to every use, check that the cutting blades **A1** or the comb attachment **A10** or **A11** are not damaged.

CUTTING HAIR WITH THE COMB ATTACHMENT

- Press the hair clipper on clean, dry or lightly dampened hair. Before cutting hair, thoroughly comb out the hair in the growth direction.
- Seat the person whose hair you will be cutting in such a way that their head is at the height of your chest. Use a towel to cover the neck and shoulders to protect clothing from hair clippings.
- Press button **A5** to release the slide lock and at the same time move the slider **A4** down all the way. Release button **A5** and attach comb attachment **A10** or **A11** on to the cutting blades **A1**. The bars on the sides of attachment **A10** or **A11** must slide into the guiding grooves on the sides of the hair clipper handle **A7**, see figure B. Push the comb attachment **A10** or **A11** downwards to attach it to the handle **A7**. This is indicated by a click.
- Press button **A5** to release the slide lock and at the same time move the slider **A4** to set the required cutting height. The maximum cutting height 24/35 mm indicator is marked in the bottom part of the groove in which the slider **A4** moves up and down. When the cutting height is set, release button **A5**. This locks in the set cutting height. If you are using the hair clipper for the first time, we recommend that you first use the high comb attachment **A11** with a higher cutting height set. Only thereafter, you can adjust the setting to a shorter cut or to use the other comb attachment **A10**, which enables the setting of an even lower cutting height.
- Turn on the hair clipper by sliding switch **A6** to the position I (on).



Attention:

The cutting blades **A1** will cut off all hair that comes into contact with them, therefore be especially careful when handling the hair clipper while it is running.

- To ensure an even haircut, the comb attachment **A10** or **A11** must constantly remain in contact with the scalp. Slowly move the hair clipper counter to the direction of hair growth.
- Regularly remove hair accumulating in the attachment **A10** and **A11**. Prior to removing the hair, turn off the hair clipper.
- When you wish to thin the hair out, slide out the hair thinning blade using slider **A2**.
- When you have finished using it, turn off the hair clipper by sliding the switch **A6** to position 0 (off) and if it was powered from an external power source, disconnect it from the power socket. Then clean it out according to the instructions in chapter Cleaning and maintenance.

TRIMMING A BEARD WITH THE COMB ATTACHMENT

- Proceed in the same way as when cutting hair. Trim the beard when it is dry without the use of shaving gels or foams.
- Trim the beard by slowly moving counter to the growth direction of the beard, going from the bottom upwards. Please remember that the comb attachment **A10** or **A11** must constantly remain in contact with the skin to ensure an even cut.

CUTTING HAIR WITHOUT THE COMB ATTACHMENT

- Use the hair clipper on clean, dry or lightly dampened hair. Before cutting hair, thoroughly comb out the hair in the growth direction.
- Seat the person whose hair you will be cutting in such a way that their head is at the height of your chest. Use a towel to cover the neck and shoulders to protect clothing from hair clippings.
- Use slider **A4** to set the shortest cutting height and then remove the comb attachment **A10** or **A11** by sliding it out away from the cutting blades **A1**. When the hair clipper is used without the comb attachment, the cut will correspond to a height of approximately 0.5 mm.
- Turn on the hair clipper by sliding switch **A6** to the position I (on).



Attention:

The cutting blades **A1** will cut off all hair that comes into contact with them, therefore be especially careful when handling the hair clipper while it is running.

- Cutting without the comb attachment is used primarily for trimming up sideburns and the ear line and the nape of the neck. When trimming the ear line, hold the hair clipper so that the cutting blades **A1** point downwards ensuring that only the cutting teeth are in contact with the hair. When trimming the line at the nape of the neck and sideburns, hold the hair clipper with the cutting blade **A1** pointing downwards and only gently touch the skin with it.
- When you have finished using it, turn off the hair clipper by sliding the switch **A6** to position 0 (off) and if it was powered from an external power source, disconnect it from the power socket. Then clean it out according to the instructions in chapter Cleaning and maintenance.

TRIMMING A BEARD WITHOUT THE COMB ATTACHMENT

- Proceed in the same way as when cutting hair. Trim the beard when it is dry without the use of shaving gels or foams.
- Trim the beard by slowly moving counter to the growth direction of the beard, going from the bottom upwards.

CLEANING AND MAINTENANCE

- Before starting to clean the hair clipper, make sure that it is turned off and disconnected from the external power source.
- Regular cleaning after every use will ensure optimal performance of the hair clipper.



Attention:

This hair clipper is not designed to be washed under the water tap. Do not spray the hair clipper or the power adapter **A12** with water or any other liquid or submerge it in water or any another liquid.

- If the comb attachment is attached to the hair clipper, remove it. Hold the hair clipper in your hand so that your thumb is positioned above on the cutting blade **A1**. Push down on the cutting blade **A1** with your thumb until the whole cutting unit is released, see figure C. Remove the cutting unit from the hair clipper handle **A7**, see figure D. Use the brush **A14** to remove all hair and beard remains from the area in which the cutting unit is located and off the cutting unit, see figure E.
- In the event that the cutting unit is heavily soiled, rinse it under clean running water, see figure F and then carefully dry it.
- After cleaning, apply several drops of oil **A15** on to the cutting unit as shown in figure G and spread it around evenly. Wipe off excess oil using a clean, dry cloth.



Note:

When the supplied oil **A15** is used up, use sewing machine oil.

- After lubricating it, attach the cutting unit back into the hair clipper handle **A7**, see figure H. Make sure that the cutting unit fits properly into its place.
- Clean out the hair clipper handle **A7** and the comb attachment **A10** and **A11** with a clean dry cloth. In the event that it is very dirty, you can use a lightly dampened cloth. Then wipe everything so that it is thoroughly dry.
- To clean the adapter **A12**, use a clean, dry cloth.
- For cleaning, never use abrasive cleaning products, solvents, etc.

REPLACING THE CUTTING UNIT

- When the hair clipper is used approximately four times per month for a duration of 20 minutes, we recommend that the cutting unit is replaced once every two years, or sooner when it shows signs of wear.
- A replacement cutting unit is available from you vendor both in online and brick&mortar stores.

STORAGE

- When you have finished using it, you may store the hair clipper in the stand **A13**. Before placing the hair clipper into the stand **A13**, make sure that the stand **A13** is located on a stable horizontal surface so that the hair clipper does not fall over.

TECHNICAL SPECIFICATIONS

Hair clipper

Input.....3.6 V $\overline{=}$, 1 A
 Battery..... Ni-MH, AAA, 2.4 V $\overline{=}$, 650 mAh
 Noise level69 dB(A)

Power adapter

Type.....TPA-593610V01
 Input 100–240 V~, 50/60 Hz, 0.3 A
 Output..... 3.6 V $\overline{=}$, 1 A

The declared noise emission level of the appliance is 69 dB(A), which represents a level A of acoustic power with respect to a reference acoustic power of 1 pW.

We reserve the right to change text and technical specifications.

INSTRUCTIONS AND INFORMATION REGARDING THE DISPOSAL OF USED PACKAGING MATERIALS

Dispose of used packaging material at a site designated for waste in your municipality.

REMOVING THE BATTERY AT THE END OF THE PRODUCT'S LIFETIME

Prior to handing over the product at a specialised collection facility, it is necessary to ensure that the built-in battery is removed. Before removing the battery, disconnect the hair clipper from the power socket and allow it to fully discharge. Take the cutting unit off the handle **A7** and using a flat screwdriver, remove the front cover of the handle **A7**. Cut off the wires and remove the battery, see figure I. Battery removal may also be performed at an authorised service centre. In the event that the product has been disassembled for the purpose of ecological disposal then it must not be reassembled.



BATTERY DISPOSAL

The battery contains environmentally damaging substances and therefore does not belong in standard household waste. Hand it over for proper disposal at respective collection locations.



DISPOSAL OF USED ELECTRICAL AND ELECTRONIC EQUIPMENT

This symbol on products or original documents means that used electric or electronic products must not be added to ordinary municipal waste. For proper disposal, renewal and recycling hand over these appliances to determined collection points. Alternatively, in some European Union states or other European countries you may return your appliances to the local retailer when buying an equivalent new appliance.

Correct disposal of this product helps save valuable natural resources and prevents potential negative effects on the environment and human health, which could result from improper waste disposal. Ask your local authorities or collection facility for more details.

In accordance with national regulations penalties may be imposed for the incorrect disposal of this type of waste.

For business entities in European Union states

If you want to dispose of electric or electronic appliances, ask your retailer or supplier for the necessary information.

Disposal in other countries outside the European Union

This symbol is valid in the European Union. If you wish to dispose of this product, request the necessary information about the correct disposal method from the local council or from your vendor.



This product meets all the basic requirements of EU directives related to it.